

Hoyer®

COMFORT SLING

INCLUDING COMFORT PAD® AND SECURI3 CLIP SYSTEM

USER GUIDE FOR THE COMFORT SLING

The Comfort Sling is an easy fit, contoured sling designed to accommodate 85-90% of clients. It is used in conjunction with the 4 point spreader bar which is designed to position patients from either a seated or reclined position. The sling is available in five sizes - extra large, large, medium, small and pediatric.

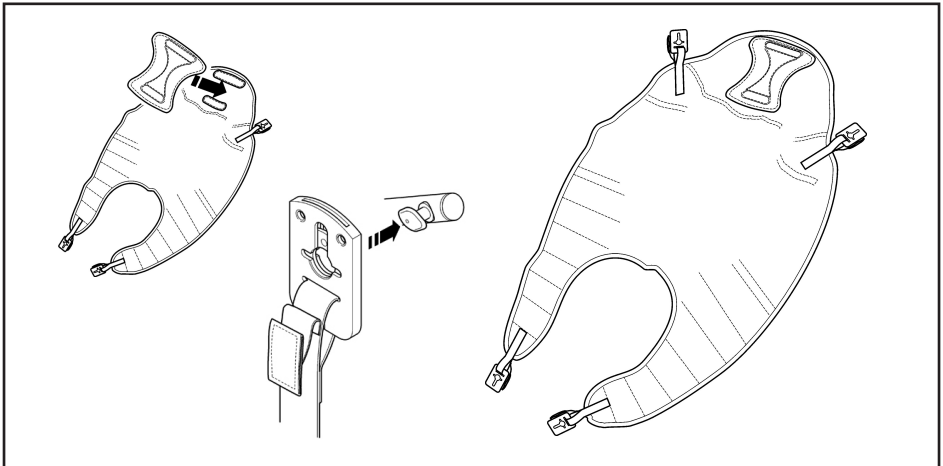

HOYER RECOMMENDS THE USE OF GENUINE HOYER PARTS.

Hoyer slings and lifters are not designed to be interchangeable with other manufacturer's products. Using other manufacturer's products on Hoyer products is potentially unsafe and could result in serious injury to patient and/or caregiver.

For the safety of the patient and carer; before using a sling a full risk assessment must be conducted to ensure that the correct sling choice, method of positioning in the sling and procedure for transfer has been determined for the patient.

Check sling and stitching before each use. Using bleached, torn, cut, frayed or broken slings is unsafe and could result in serious injury or death to the patient.

Destroy and discard worn slings. Do not alter slings.

Never leave a patient unattended.



ADDITIONAL SLINGS ARE AVAILABLE TO SUIT INDIVIDUAL NEEDS.
YOU ARE ADVISED THAT YOU SHOULD ALWAYS SEEK THE ADVICE OF AN
AUTHORISED DEALER BEFORE PURCHASING.

WE WILL BE PLEASED TO ADVISE YOU OF YOUR NEAREST AUTHORISED DEALER.

Joerns

HOW TO FIT FROM SEATED POSITION

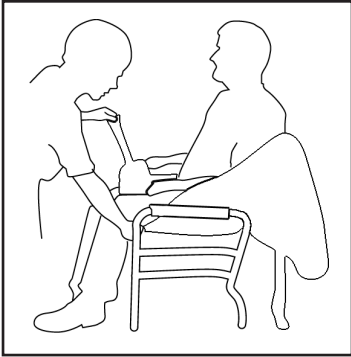

The comfort sling is fitted to the patient in the traditional way. Fitting from the seated position requires the care-giver to raise the clients leg and feed the leg support piece under and up between the legs. Repeat this procedure for other leg. Ensure the sling is not twisted or creased under the thigh. Bring both leg pieces together and feed through the modesty strap.

Position the rear section of the sling up and around the shoulders and head, the client is then ready for lifting.

HOW TO FIT SLING FROM LYING POSITION

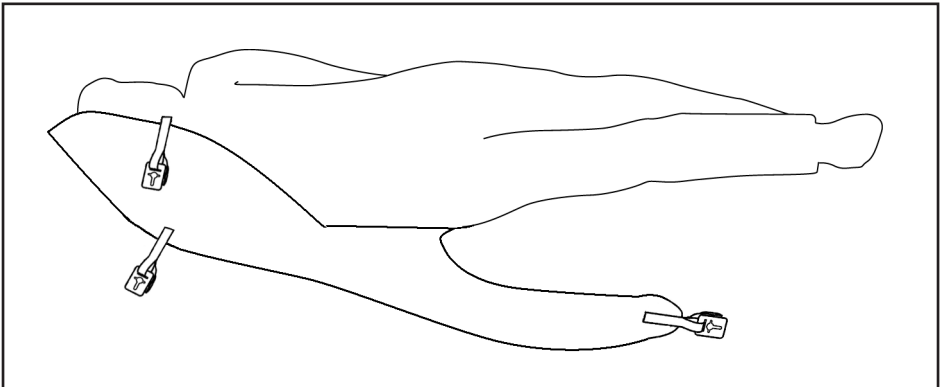

Draw sheet roll the client onto the sling, ensuring that the top of the commode aperture is at the base of the spine. Position the spreader bar as shown opposite and the client is ready for lifting.

GOLDEN TIPS

- 1. THE CLIENT'S POSTURE CAN BE ALTERED PUSHING DOWN ON SPREADER BAR PIVOT HANDLE (SEE OPPOSITE).**
- 2. ATTACH SECURI3 CLIPS TO THE SPREADER BAR AS DESCRIBED OPPOSITE.**
- 3. ENSURE ALL GREEN SAFETY LOOPS ARE VISIBLE BEFORE LIFTING.**

HOW TO FIT THE SLING TO THE 4 POINT SPREADER BAR

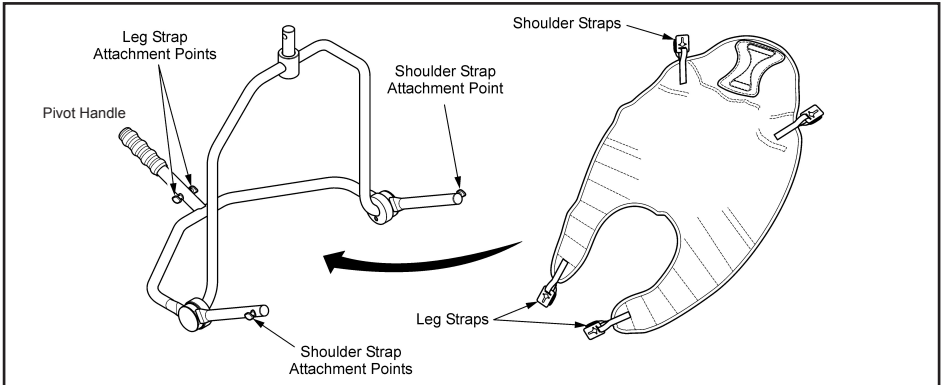

When fitted to the patient, the sling is connected to the 4 point spreader bar by using the Securi3 clip system (step by step guide as follows). To remove, simply reverse this procedure.

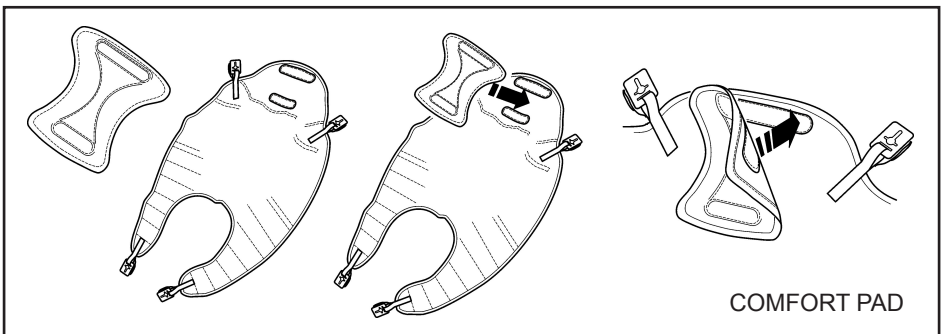
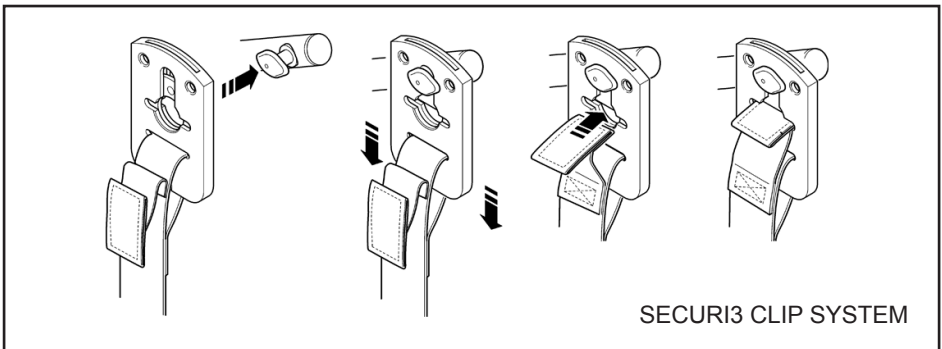

The Comfort Pad must be applied as it provides additional comfort and support to the client. **Do not** lift without the Comfort Pad correctly in position. The Comfort Pad is available in different thicknesses providing increased levels of support/comfort.

COMFORT SLING TECHNICAL SPECIFICATIONS

STANDARD	BS EN ISO 10535
SAFE WORKING LOAD	500lbs / 227kg

SIZING

Each sling is marked with the following colour coded symbols, four of which will be crossed. Your sling is the uncrossed size, i.e. in this example Small (Red).

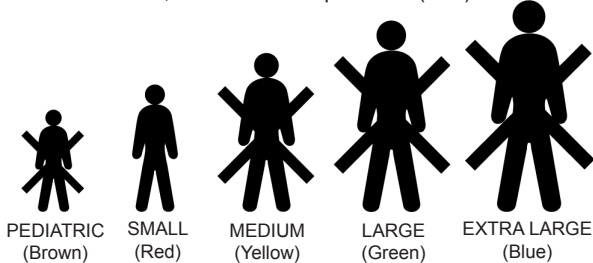

WASHING INSTRUCTIONS

Each sling is marked with the following washing instructions:

DO NOT WASH WITH BLEACH

Bleach will damage material. Slings can suffer damage during washing and drying. Check sling before each use. Bleached, torn, cut, frayed or broken slings are unsafe and could result in serious injury or death to patient. Destroy and discard worn slings. Do not alter slings. Machine wash warm. Cool tumble dry, air dry or dry at very low temperature.



		Comfort (Polyester)	Comfort Padded (Polyester)	Comfort (Net)
ORDER CODE	PEDIATRIC (BROWN)	NA25501	NA25506	NA25511
	SMALL (RED)	NA25502	NA25507	NA25512
	MEDIUM (YELLOW)	NA25503	NA25508	NA25513
	LARGE (GREEN)	NA25504	NA25509	NA25514
	EXTRA LARGE (BLUE)	NA25505	NA25510	NA25515



Joerns Healthcare
 2100 Design Road, Suite 100
 Arlington, TX 76014
 Tel: 800-826-0270
 Fax: 800-457-8827
www.joerns.com